

SMARTair Wireless Escutcheon



Function

SMARTair provides access control to several access points or many, via a wireless network to self-contained locksets. Embedded with MIFARE or HID iClass smart card technology, SMARTair provides High Security with convenient operation.

Applications

Access control for commercial and institutional facilities, including offices, hospitals, factories, schools, sports clubs and more. SMARTair is controlled directly from the system manager's PC, and immediately notifies managers about pre-defined events, enabling management to change authorizations and schedules and even open distant doors directly from their PC.

Features

- Wire-free installation
- Simple operation
- System management through easy-to-use software
 - Authorizations
 - Time schedules
 - Daylight savings time and holidays
 - Deletion and replacement of lost tags
 - Online event log
 - Remote opening of doors
 - Remote updating of authorizations and schedules via HUB
 - Instant cancellation of lost user cards
 - Temporary blockage
 - 4-digit code
 - 4 operation modes: Standard, Open, First user, Dual card
- Up to 64,000 user cards and up to 64,000 doors per system

Specifications

- For installation on new or existing doors
- Contactless chip identification technologies 13.56 MHz ISO 14443A
- MIFARE CLASSIC, 1K, 4K and ULTRALIGHT or iClass.
- 2 possible memory configurations:
 - 1,500 users and 600 events in the event log
 - 1,000 users and 1,000 events in the event log
- Door thickness: 33-110mm
- IP54 (external installation model)
- RF frequency: 868 MHz
- 2 to 4 cm read/write distance
- Visual indication of operational status (authorized, not authorized, out of schedule, low battery)
- Humidity: Up to 85% without condensation
- Temperature range dependant on battery type:
 - Alkaline batteries: 0°C to 65°C
 - Lithium batteries: -40°C to 75°C
- Powered by 3 x AA batteries
- Fire resistance: Tested to EN1634:2000 for 30, 60, 90 minutes



SMARTair Wireless Escutcheon (continue)

Options

- Internal & external installation models
- Long plate or short plate
- Handles: SENA, DELTA, ARCO and more
- Finish: Stainless steel, satin chrome, PVD polish brass and more
- Various distances between axes (70mm-105mm)
- Spindle: 7mm, 8mm, 9mm
- Various cylinder applications: Euro, Swiss, oval and more
- May be installed with or without cylinder; cylinder can be visible or hidden
- Privacy feature
- Installation with a Panic Exit Device (PED)
- With or without keypad (with keypad is not available as Standalone)
 - RFID only
 - RFID and code
 - Code only

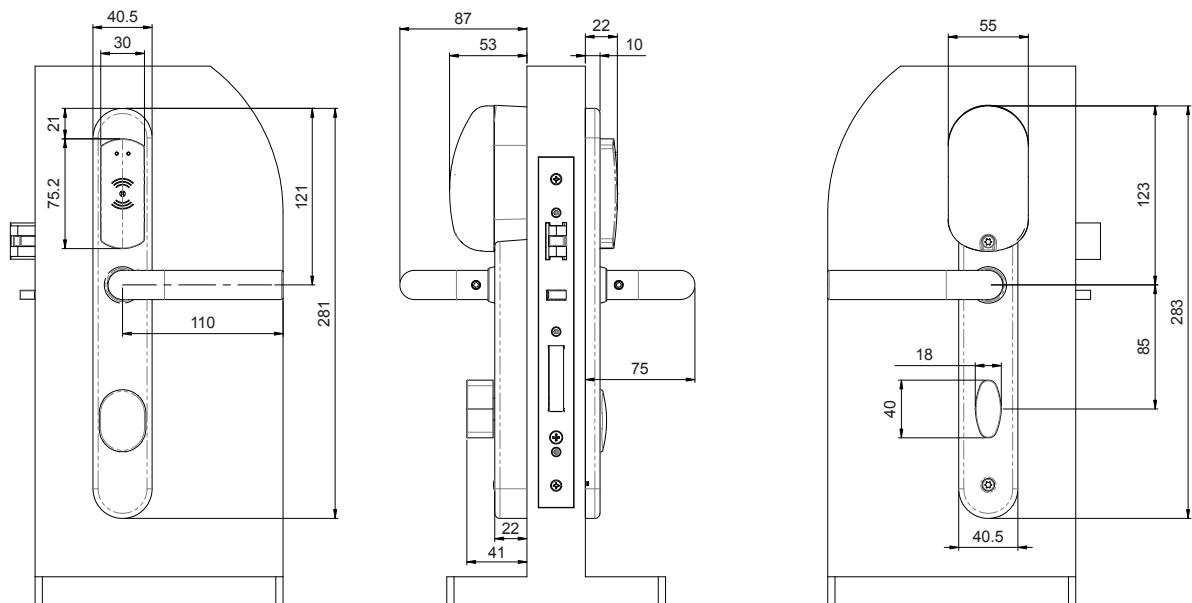

EDS